



ITT

Wastewater

Red Jacket Water Products

2DF Submersible
Dewatering Pump



FEATURES

- **Impeller:** Polyurethane for wear and corrosion resistance.
- **Adjustable Discharge:** Discharge can be installed for either vertical or horizontal installation using only 2 screws.
- **Diffuser:** Polyurethane for wear and corrosion resistance.
- **Mechanical Seal:** Dual seals for double leakage protection, outer seal – silicon carbide.
- **Rubber Liner:** Protects against wear around impeller.
- **Bottom Strainer:** Made of impact absorbing EPDM rubber, suction holes allow for low pump down.



Red Jacket Water Products is a brand of ITT Water Technology, Inc. - a subsidiary of ITT Industries, Inc.

www.redjacketwaterproducts.com

Engineered for life



ITT

RED JACKET WATER PRODUCTS Wastewater

APPLICATIONS

Specifically designed to remove water from:

- Drainage ditches
- Trenches
- Basements
- Manholes
- Excavating drainage in the building trades

SPECIFICATIONS

Pump:

- Discharge size: 2" threaded hose coupling design.
- Capacities: up to 84 GPM.
- Total heads: up to 51 feet.
- Max. solids: any particles passing through strainer.

- Mechanical seals: outer seal – silicon carbide, inner seal – carbon ceramic.
- Temperature limit: 95°F (35° C) maximum.
- Depth of immersion: 16.5 feet (5m) maximum.

Motor:

- Single phase: 3500 RPM, ½ HP and 1 HP, 115 and 230 V, 60 Hz
- Built-in starter with full overload and temperature protection.
- Class F insulation.
- Air filled design.
- Upper and lower heavy duty ball bearing construction.
- Power cord: 50 feet.

AGENCY LISTINGS



Tested to UL778 standards by Canadian Standards Association.

NRTL File #LR13533

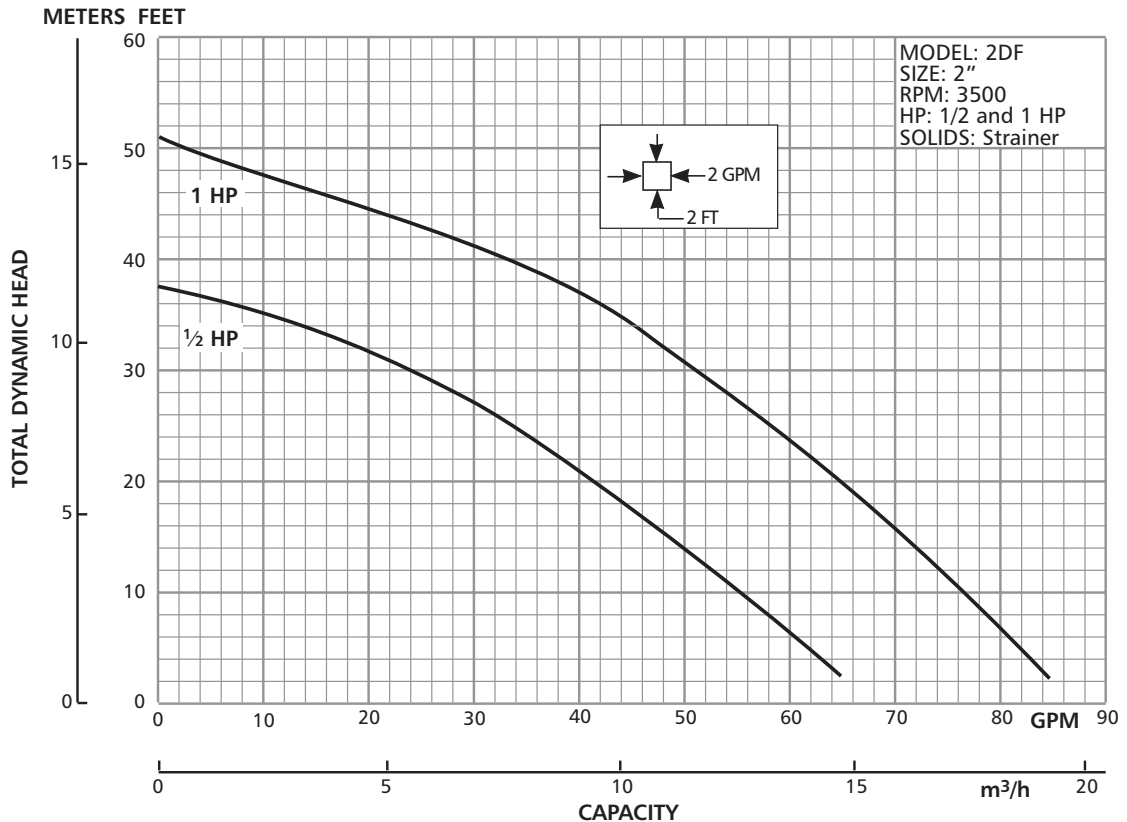

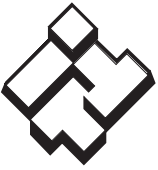

ITT

RED JACKET WATER PRODUCTS Wastewater

REPLACEMENT KITS

Each kit contains the following parts:

Impeller Kit (15K11 for 1/2 HP, 15K12 for 1 HP) – Impeller, impeller screw, protective plug, washer, assembly instruction

Diffuser Kit (15K62 for both 1/2 HP and 1 HP) – Diffuser, barrel nuts, screws, washers, assembly instruction, sticker

Outer seal Kit (15K14 for both 1/2 HP and 1 HP) – Mechanical face-seal unit, assembly instruction, sticker

See the Repair Part page for other available parts.

DIMENSIONS

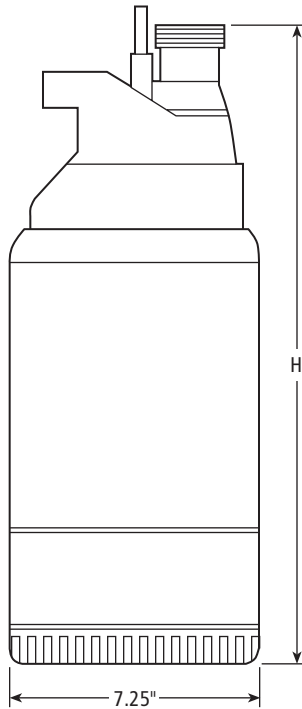

MODEL INFORMATION

Order No.	HP	Volts	Phase	Max. Amp	RPM	H (in.)	Wt. (lbs.)
2DF0511	1/2	115	1	5.5	3500	15.75	20
2DF0512		230		2.9			
2DF1011	1	115		9.8		17	25
2DF1012		230		4.9			



ITT

Wastewater

COMPONENTS

Item No.	Description
1	Discharge
2	Power cord
3	Handle/cover
4	Support bearing
5	Pump casing
6	Main bearing
7	Inner mechanical seal
8	Outer mechanical seal
9	Impeller
10	Suction cover
11	Strainer
12	Oil plug
13, 14	Motor

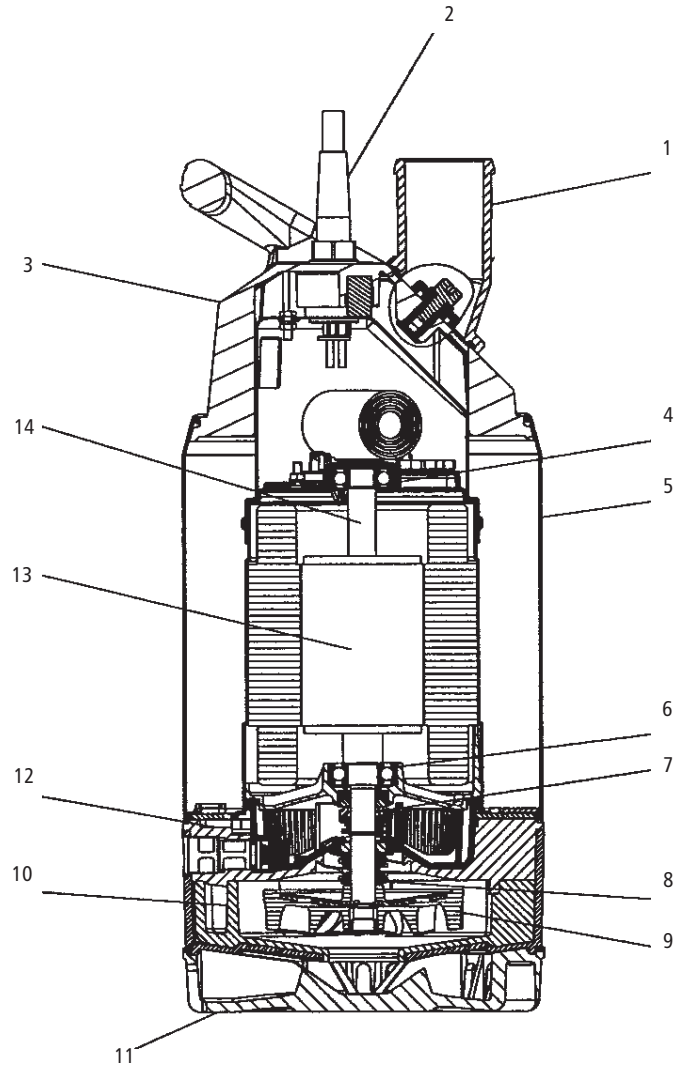

Red Jacket Water Products is a licensed trademark. Big-Flo and the ITT Engineered Blocks Symbol are registered trademarks and tradenames of ITT Industries, Inc.

SPECIFICATIONS ARE SUBJECT TO CHANGE WITHOUT NOTICE.

BRJ2DF R2 February, 2006

© 2006 ITT Water Technology, Inc.

Engineered for life